

REDMOND CENTRAL CONNECTOR

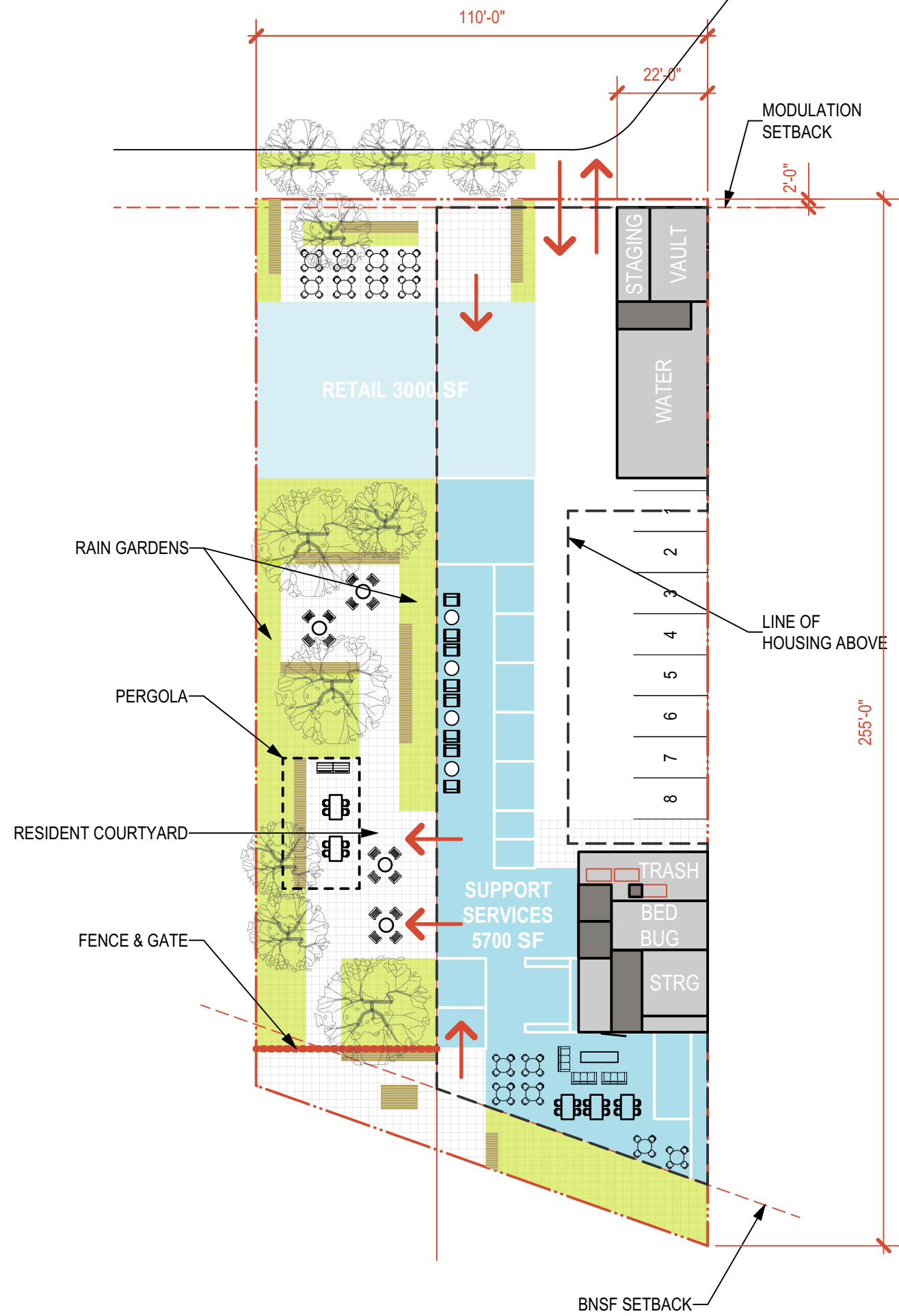

WALSH
CONSTRUCTION CO.

Plymouth Housing
Building Hope. Transforming Lives.

Environmental Works
COMMUNITY DESIGN CENTER

402 15th Avenue East
Seattle, Washington 98112
206.329.8300
206.329.5494 fax

PSH REDMOND

16725 CLEVELAND ST
Redmond, WA

05 MARCH 2024
Proj. No. 24-005

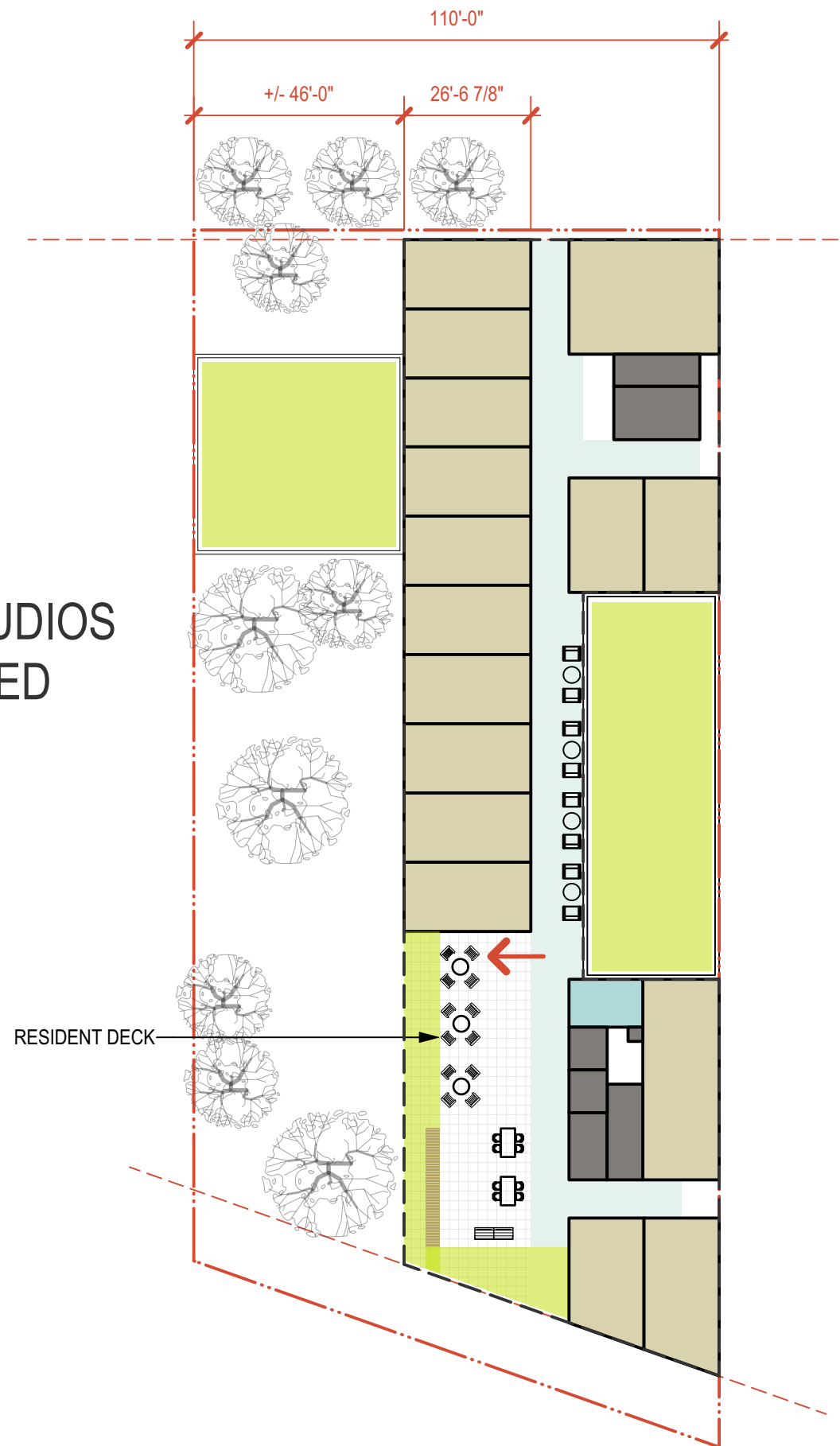

90 - STUDIOS
10 - 1 BED

RESIDENT DECK

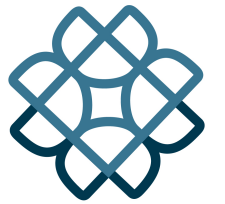

Environmental Works
COMMUNITY DESIGN CENTER

402 15th Avenue East
Seattle, Washington 98112
206.329.8300
206.329.5494 fax

PSH REDMOND

16725 CLEVELAND ST
Redmond, WA

05 MARCH 2024

Proj. No. 24-005

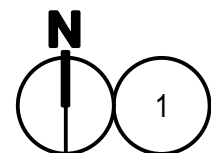

LEVEL 2 - FLIP FLOP PLYMOUTH PARK

SCALE: 1/32" = 1'-0"

A2.0