

REDMOND CENTRAL CONNECTOR

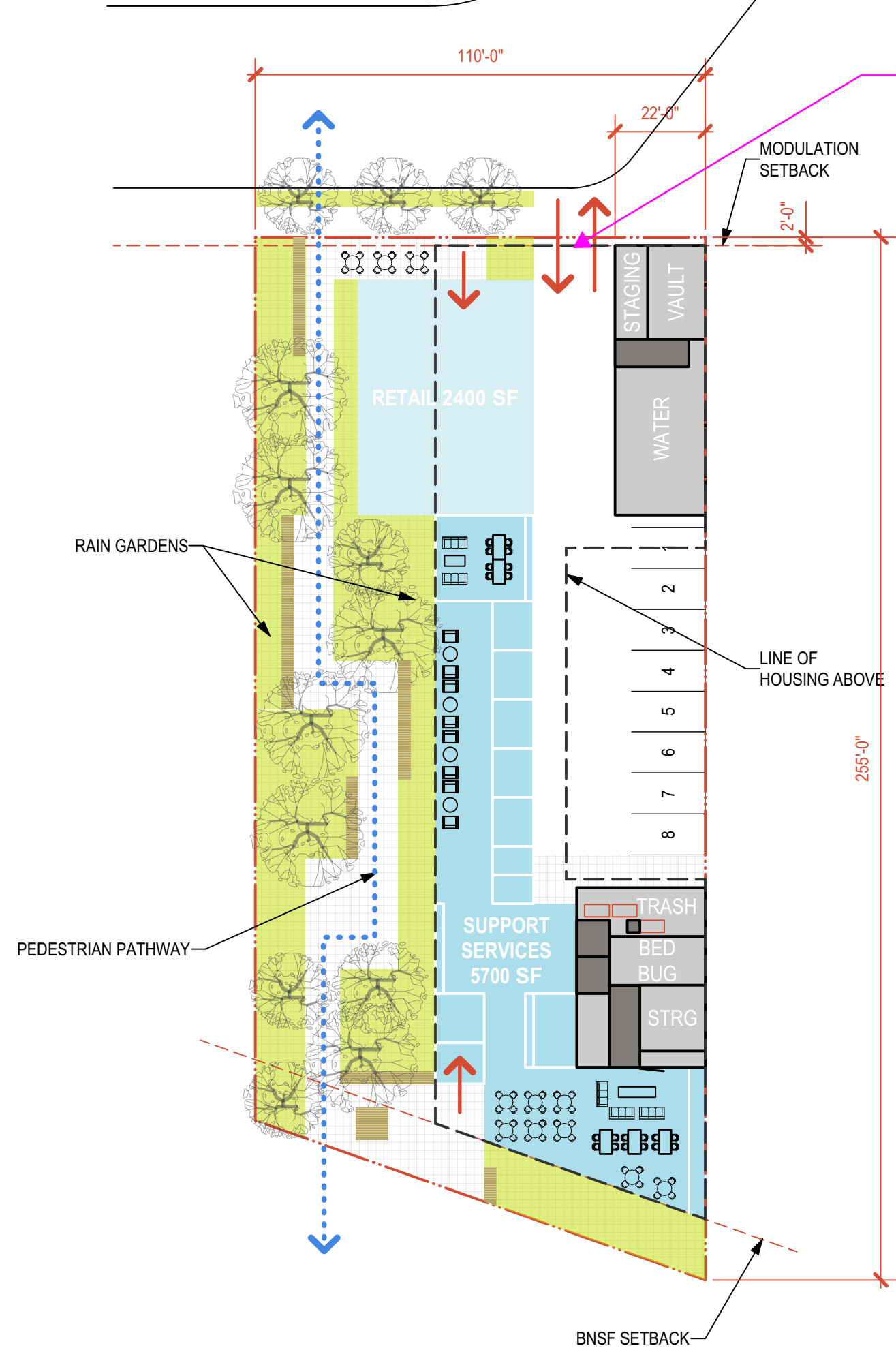

ACCESS TO CLOSE TO THE CORNER, BETTER TO HAVE ACCESS TO THE WEST

Walsh Construction Co.
Plymouth Housing
 Building Hope. Transforming Lives.
Environmental Works
 COMMUNITY DESIGN CENTER
 402 15th Avenue East
 Seattle, Washington 98112
 206.329.8300
 206.329.5494 fax

PSH REDMOND

16725 CLEVELAND ST
 Redmond, WA

05 MARCH 2024
 Proj. No. 24-005

LEVEL 1 -FLIP FLOP POCKET PARK
 SCALE: 1/32" = 1'-0"

A1.0

PRO'S

- :: BIGGER UNITS
- :: NORTH & SOUTH LIGHT

CON'S

- :: MORE DOUBLE LOADED

90 - STUDIOS
10 - 1 BED

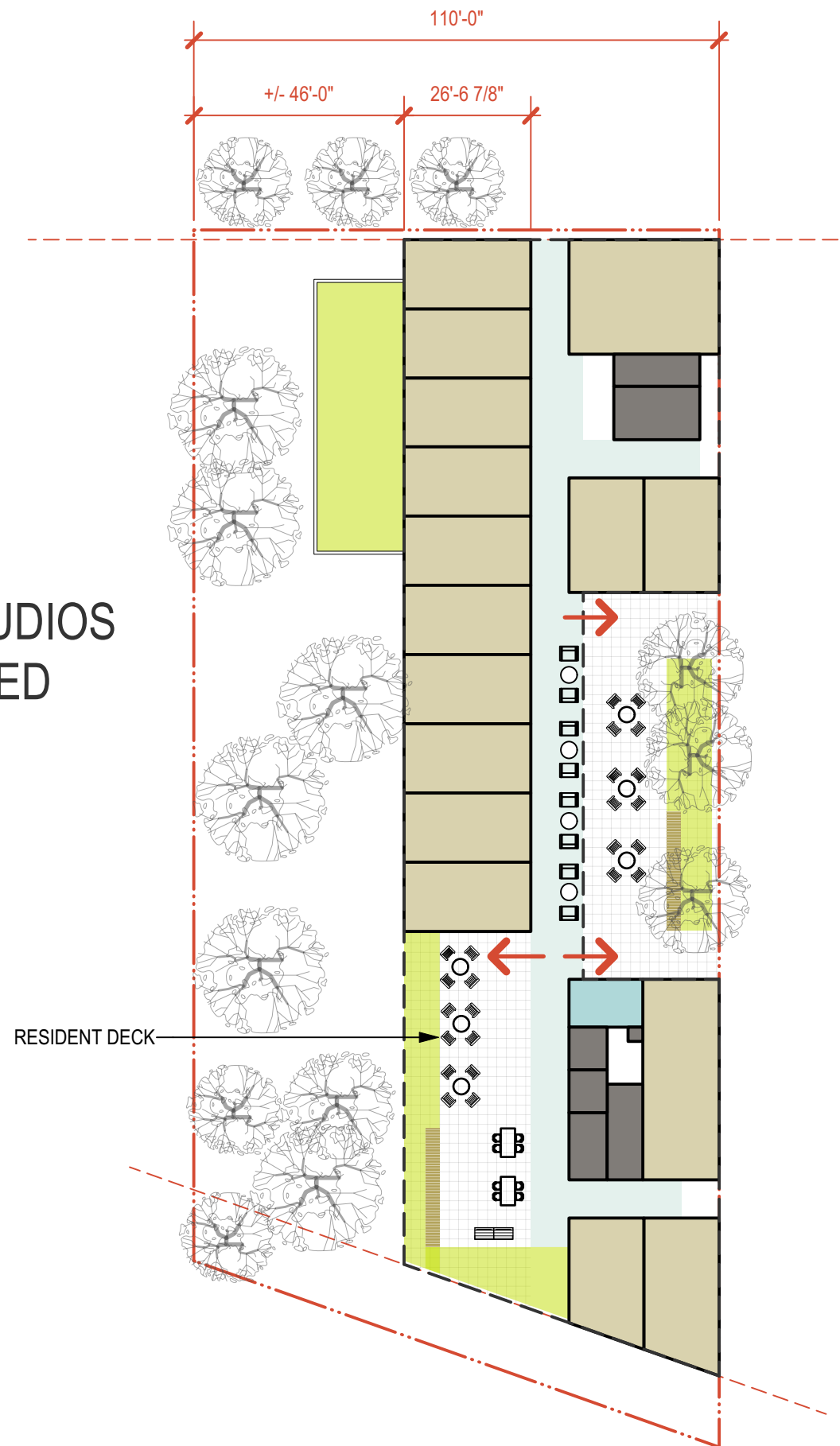

WALSH
CONSTRUCTION CO.

Plymouth Housing
Building Hope. Transforming Lives.

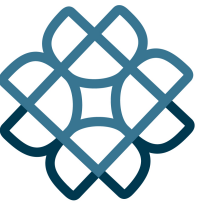

Environmental Works
COMMUNITY DESIGN CENTER

402 15th Avenue East
Seattle, Washington 98112
206.329.8300
206.329.5494 fax

PSH REDMOND

16725 CLEVELAND ST
Redmond, WA

05 MARCH 2024

Proj. No. 24-005

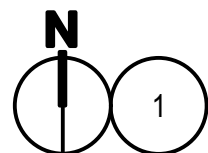

LEVEL 2 - FLIP FLOP POCKET PARK

SCALE: 1/32" = 1'-0"

A2.0